



COQUILLE INDIAN TRIBE

KILKICH TRANSPORTATION SAFETY PROJECT

LOCATION

Kilkich Reservation,
Intersection of Miluk Drive &
Mexeye Loop

CONSTRUCTION DATES

Kick-off: Mobilization: May
Phase 1: Mexeye Loop: June -July
Phase 2: Miluk Drive: July-August
Phase 3: LC Parking Lot:
August- September
Phase 4: Sidewalk to Cape Arago:
September-October

COMPLETION DATE

Est. October 2023

CONSTRUCTION COST

Est. around \$1.5 million

SIGN UP FOR UPDATES

We strongly encourage you to sign up for Construction Updates through [Nixle!](#) TEXT keyword "BUILD" to 888777. Updates will be provided weekly throughout the project.

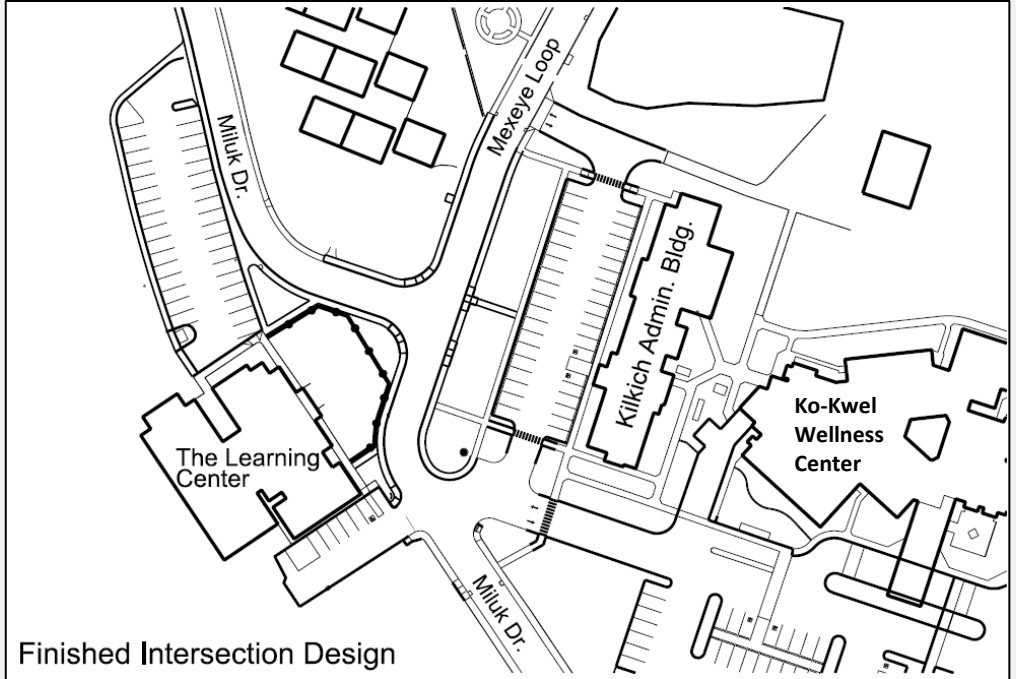

PROJECT DETAILS

The Kilkich Transportation Safety Project corrects a long-standing issue identified in the Empire Comprehensive Plan and the overall Tribal Compressive Plan. The current "wye" intersection of Miluk Drive and Mexeye Loop is dangerous for vehicles and pedestrians and difficult to navigate. The lack of sidewalks along Miluk drive between the Learning Center, CELS, and Cape Arago is also a serious pedestrian safety issue.

The Tribe has contracted with Knife River Materials (KRM) to realign the current "wye" intersection of Miluk Drive and Mexeye Loop into a 3-way "tee" intersection. The project will also include extending the sidewalk on the north side of Miluk Drive, west of CELS, to Cape Arago Highway, for pedestrian safety; as well as combining the existing paved and gravel parking lots and adding a sidewalk to the west of the Learning Center.

Construction is set to begin May 26, 2023, and complete October 1, 2023. The project will be phased to allow traffic to continue to flow through the reservation, with detouring in place.

Funding for this project was secured through a \$1M Federal Highway Administration Tribal Transportation Safety Grant and \$500K from The Bureau of Indian Affairs (BIA) Tribal Transportation Project funds.

Construction updates will be provided weekly, detailing work completed, what to expect the following week, detouring and alternate parking information, as well as mitigation efforts for noise and dust.

Please see the reverse for more project details. 

PHASE 1 – MEXEYE LOOP

Mid-June to Mid-July

Construction will begin with demolition and excavation of Mexeye in the highlighted area. Installation of power and communication lines for future developments will occur in the area to the north. New curbs, gutters, sidewalks, and asphalt will be installed. Towards the beginning of this phase, the wooded debris on the cranberry bogs will be cleaned up. Traffic will be diverted off Miluk drive through the Administration Building parking lot and back on to Mexeye Loop.

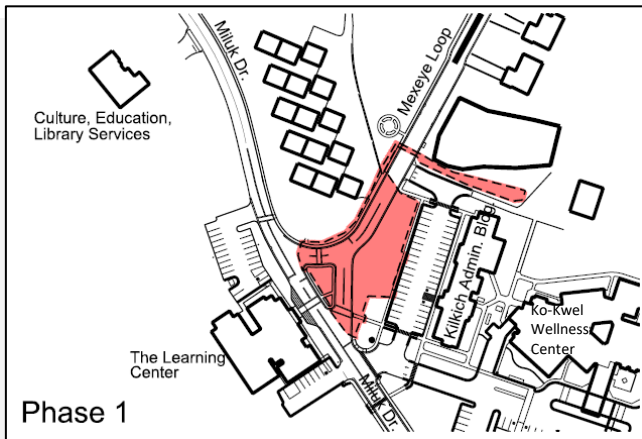

PHASE 2 – MILUK DRIVE

Mid-July to Mid-August

Construction will continue in Phase 2 with the demolition and excavation of Miluk Drive in front of the Learning Center. A new "courtyard" will be installed in front of the Learning Center with improvements continuing in Phase 4. New curbs, gutters, sidewalks, and asphalt will be installed. During this phase, traffic will be diverted off Miluk drive onto the newly paved Mexeye Loop, through the Administration Building parking lot and back on to Miluk Drive.

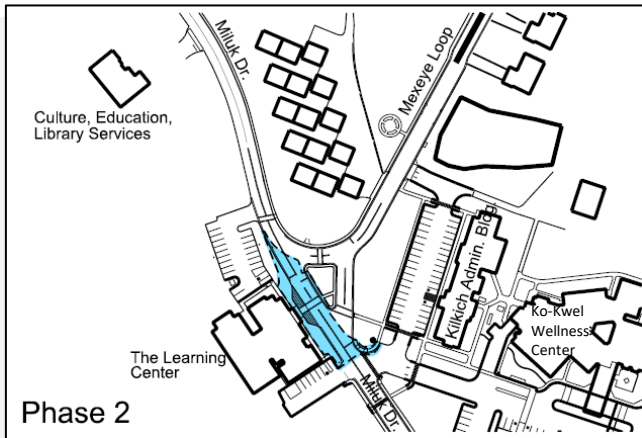

PHASE 3 – LEARNING CENTER PARKING LOT

Mid-August to Mid-September

In Phase 3, the gravel lot to the west of the Learning Center will be added to the existing parking lot. The area will be paved and striped with new sidewalks connecting to CELS as well as new lighting for safety and visibility.

Alternate parking instructions will be distributed closer to the start of this phase.

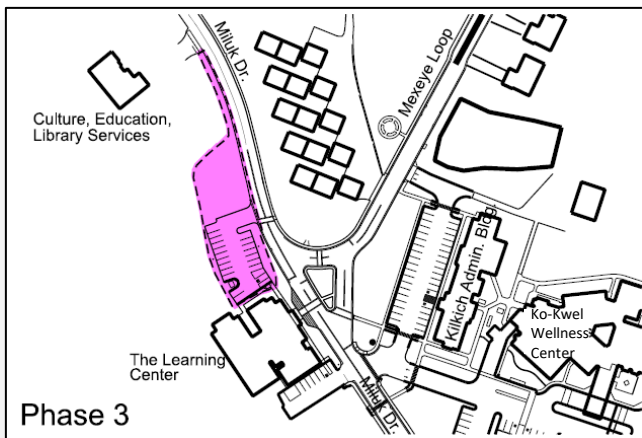

PHASE 4 – MILUK DRIVE SIDEWALK TO CAPE ARAGO

Mid-September to Mid-October

The final phase will include adding a new sidewalk on the North side of Miluk Drive down to Cape Arago Highway. New fencing and landscape improvements will finish off the new "courtyard" in front of the Learning Center, creating an inviting multiuse area.

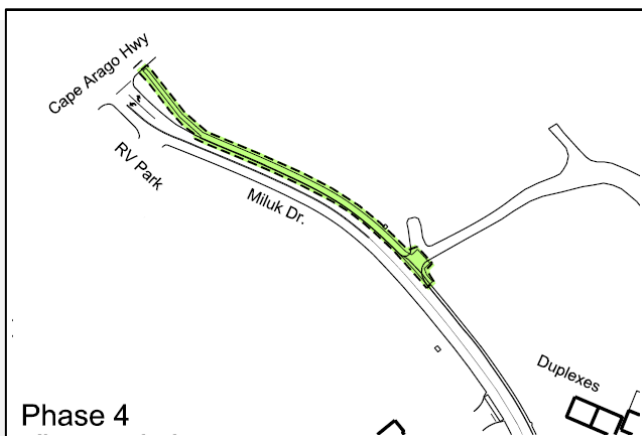



COQUILLE INDIAN TRIBE

KILKICH TRANSPORTATION SAFETY PROJECT PHASE 1 UPDATE • May 19, 2023

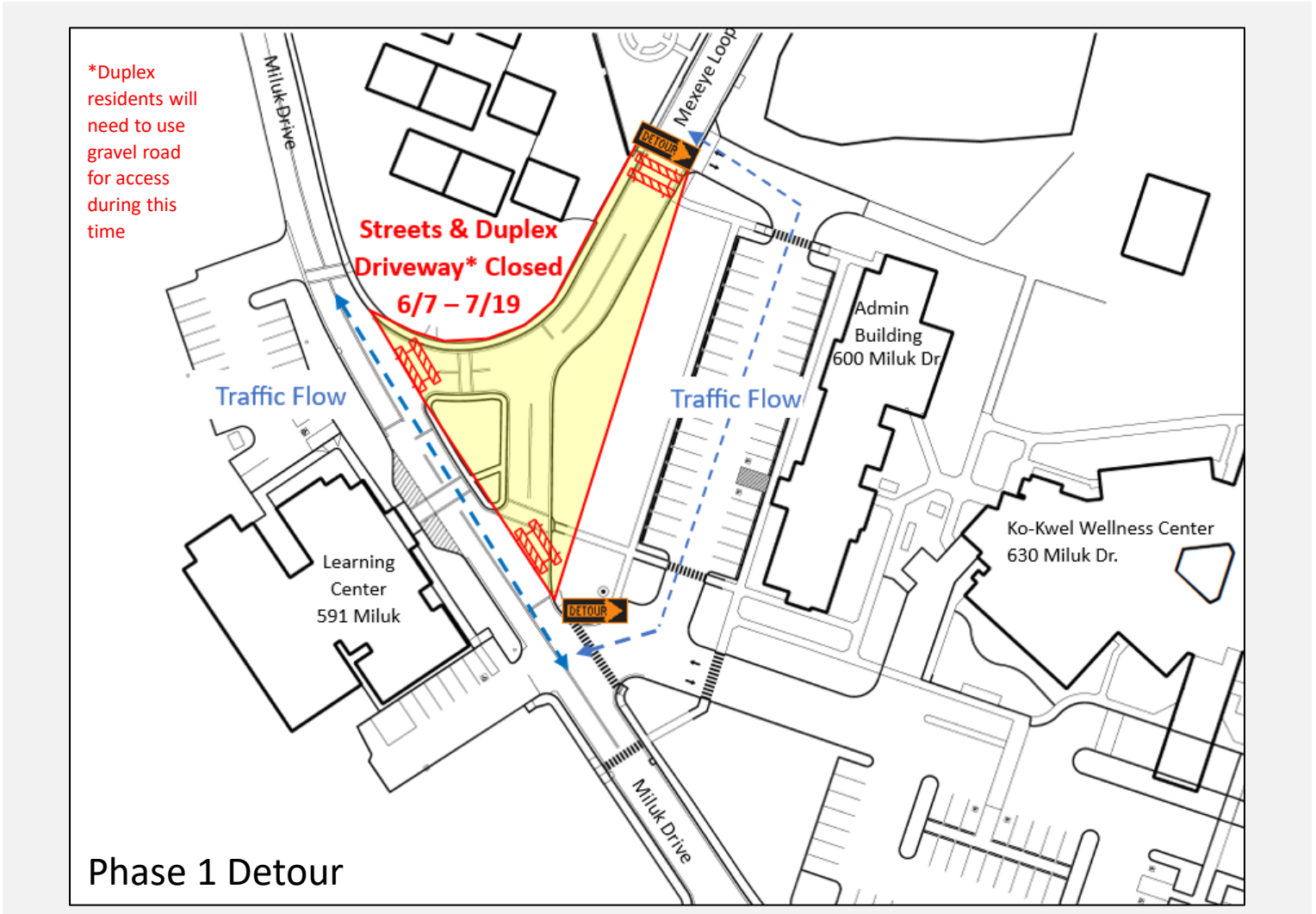

ACTIVITIES, ROAD CLOSURES, & DETOURS

The Kilkich Transportation Safety Project kicks off at the end of May. Knife River Materials will begin staging equipment to the northeast of the Kilkich Administration building. Safety signage and environmental protection will be installed on May 23rd and 24th.

Beginning June 7th, Mexeye Loop will be closed in the area highlighted in yellow above. The road is expected to reopen July 19th. Barricades will be installed, and a detour will be in place. The detour will guide traffic off Miluk/Mexeye through the Kilkich Administration Building parking lot. The detour is expected to be in place through late July.

SIGN UP FOR UPDATES

We strongly encourage you to sign up for Construction Updates through [Nixle!](#) TEXT keyword "BUILD" to 888777. Updates will be provided weekly throughout the project.

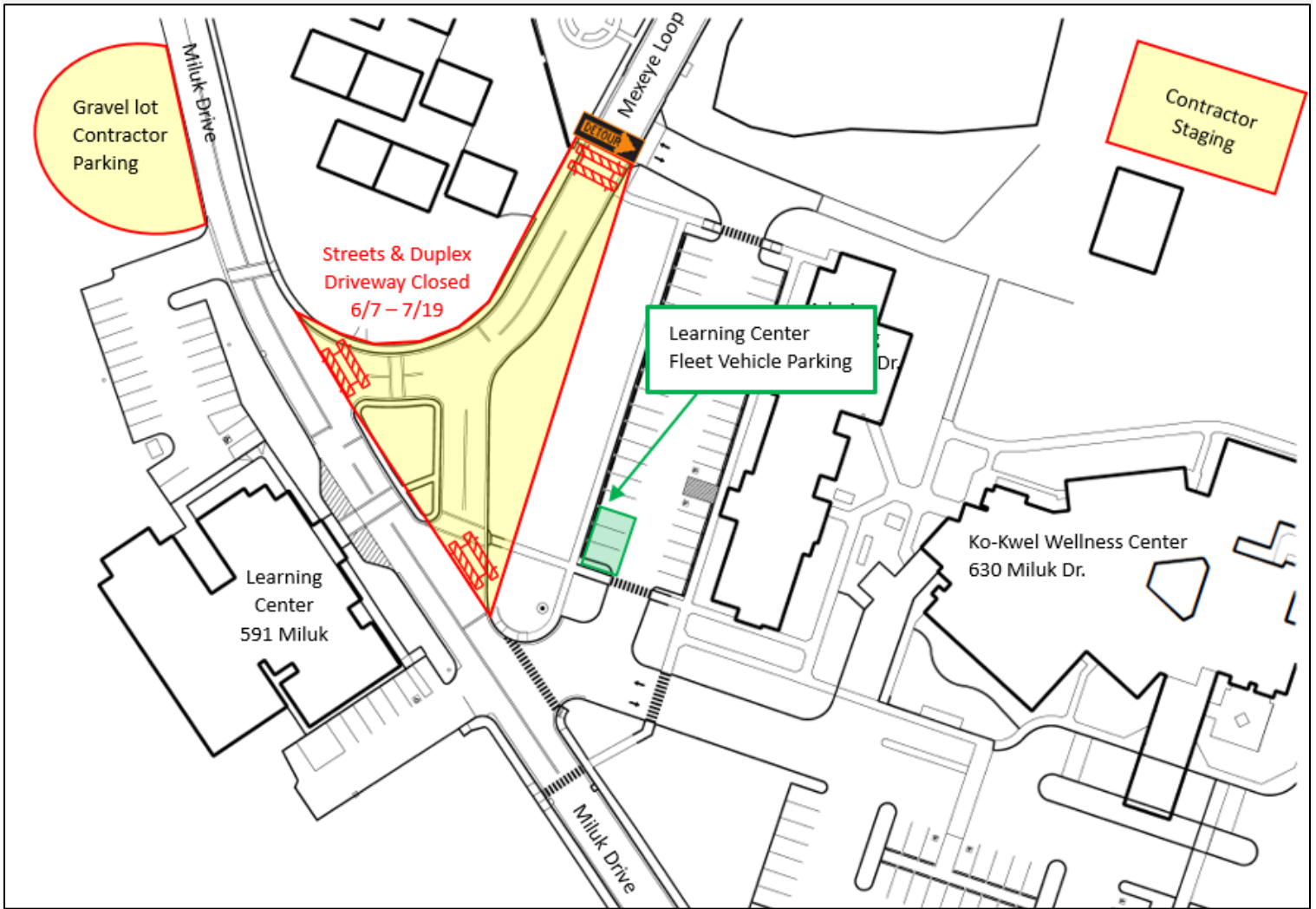

PARKING CHANGES

Knife River Materials and their subcontractors will be utilizing the gravel lot to the west of the Learning Center for vehicle parking, this phase of the project. This does not include heavy equipment which will be in the staging area to the northeast of the Kilkich Administration Building. Learning Center fleet vehicles will park in the 3 designated spots marked in green above.